

BURNSIDE

ASSEMBLY INSTRUCTIONS

W-FRAME STARTER // 292-WF-STR

Use to build a stand-alone Burnside wall system.

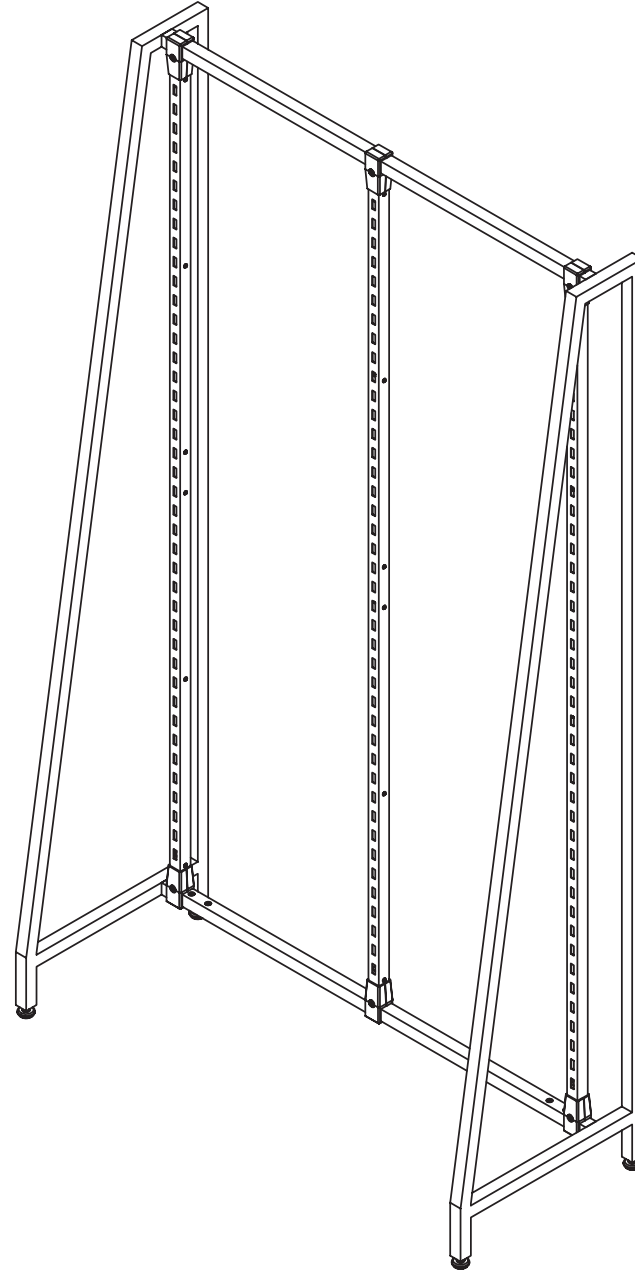

PARTS LIST:

1. End Frame - Left - (1)
2. End Frame - Right - (1)
3. Top & Bottom Rail - (2)
4. Upright Center - (1)
5. Upright Sides - (2)
6. Joint Connector Single - (6)
7. 3/8"-16 TPI Leveler - (4)
8. Socket Countersink Head Screw
1/4"-20 X 0.625"
9. SBHC SCREW #10 - 24 X 0.375" - (24)
10. Joint Connector Bolt
1/4"-20 X 0.625" (6)
11. HEX NUT 1/4" - 20 TPI (6)
12. Allen Wrench

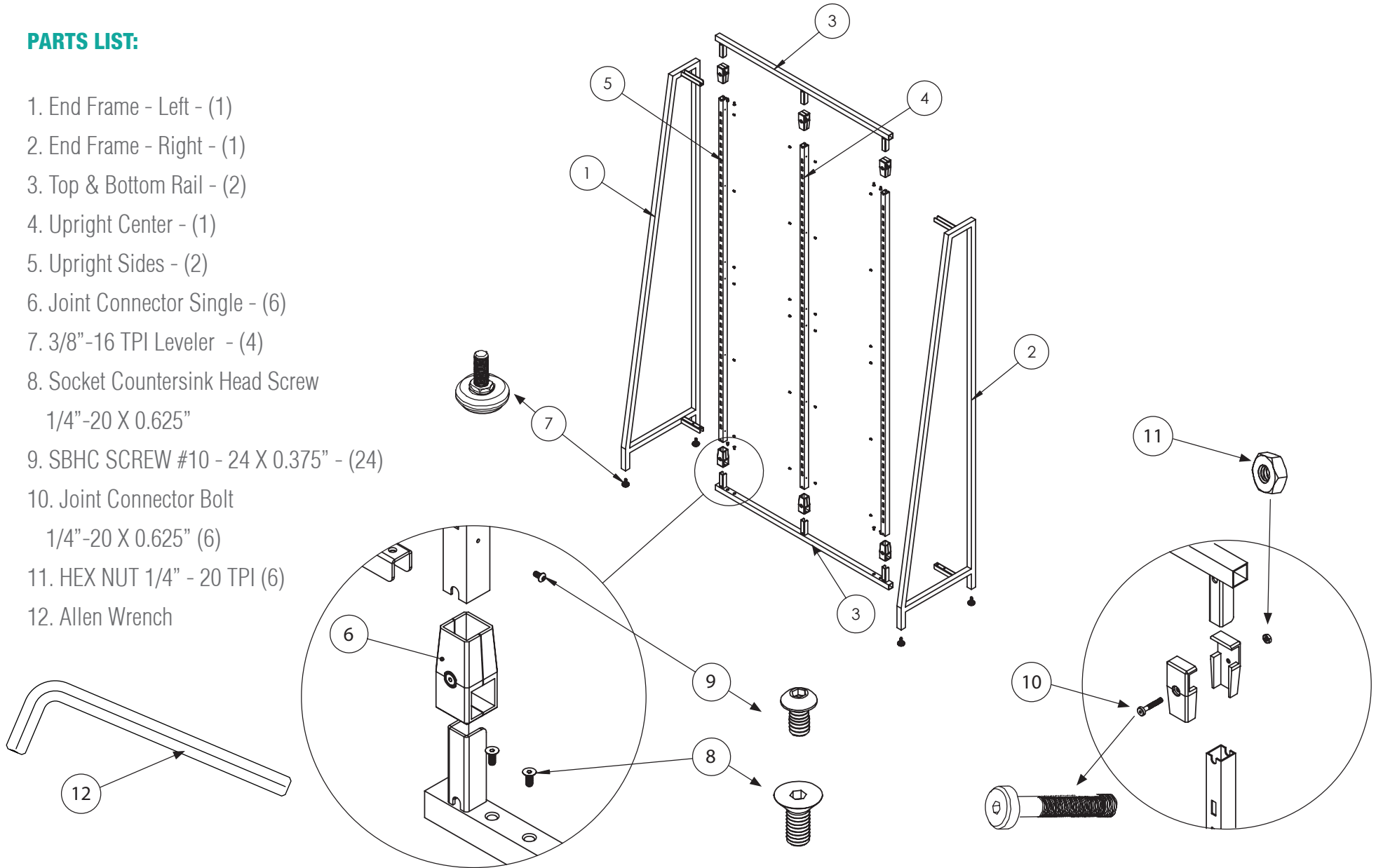

STEP 1:

Attach Upright Sides & Center to Top & Bottom Rails with Joint Connectors. Use Joint Connector Bolts & Hex Nuts and secure with Allen Wrench.

NOTE: The Upright Center will have holes on both side while the Upright Sides will only have holes on the inside of the frame.

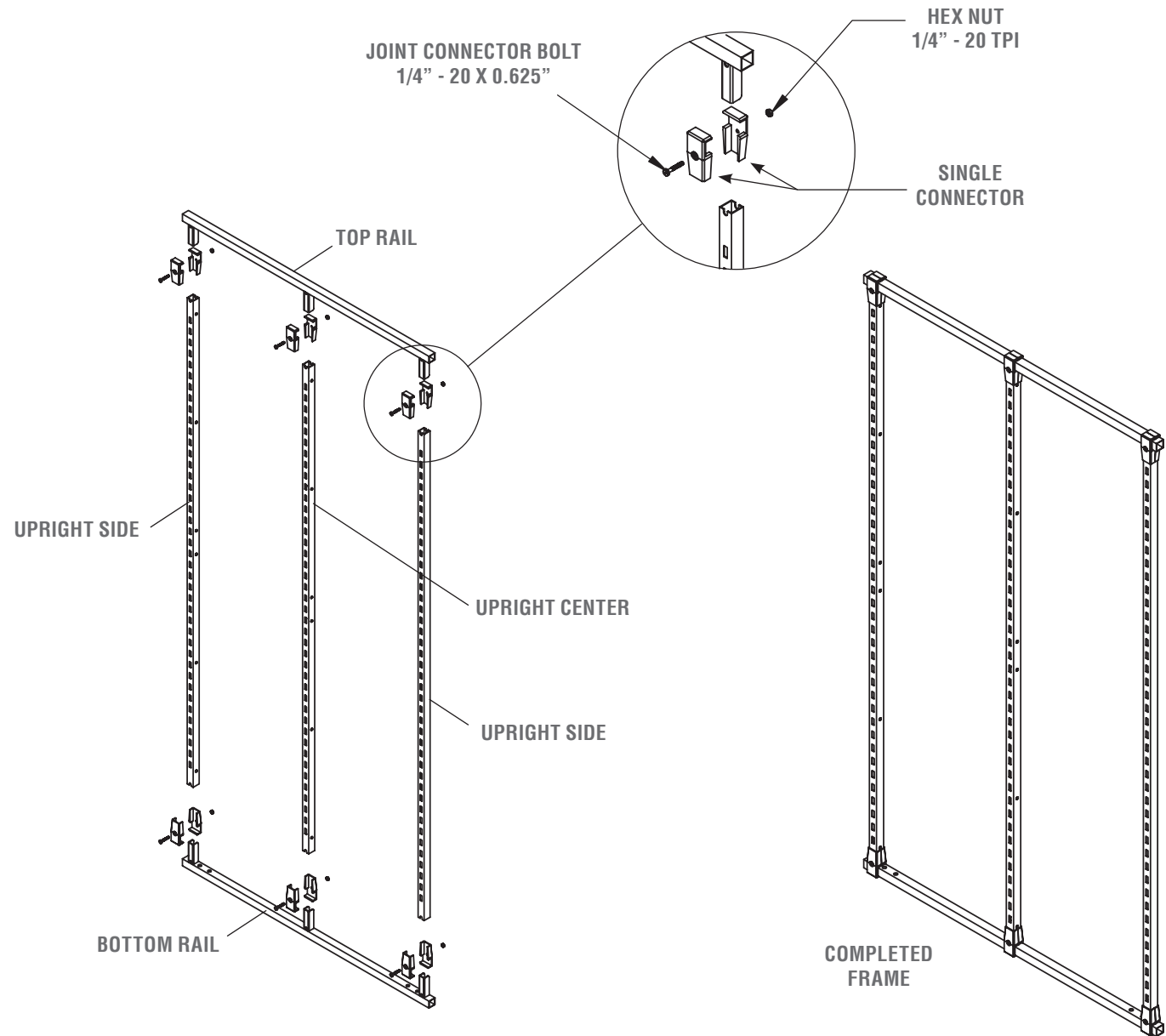

STEP 2:

Slide End Frames into existing slots at the top & bottom of the completed frame. Secure with Socket Counter-sunk Head Screws with provided Allen wrench.

STEP 3:

Attach Levelers.

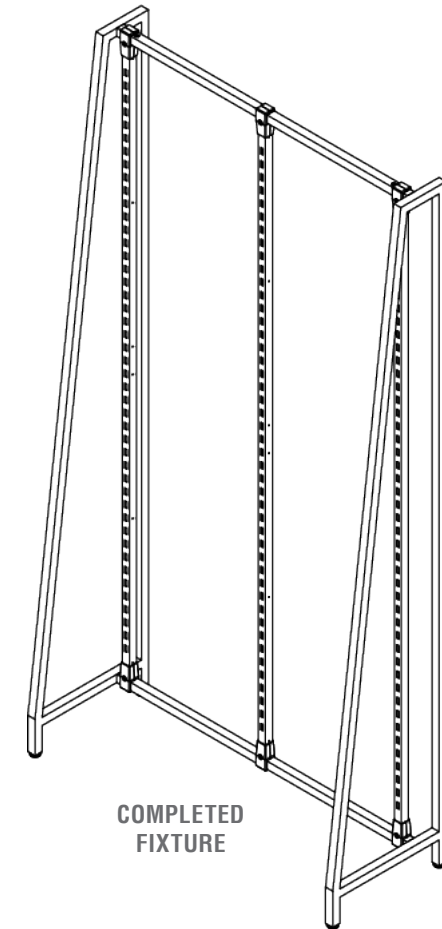
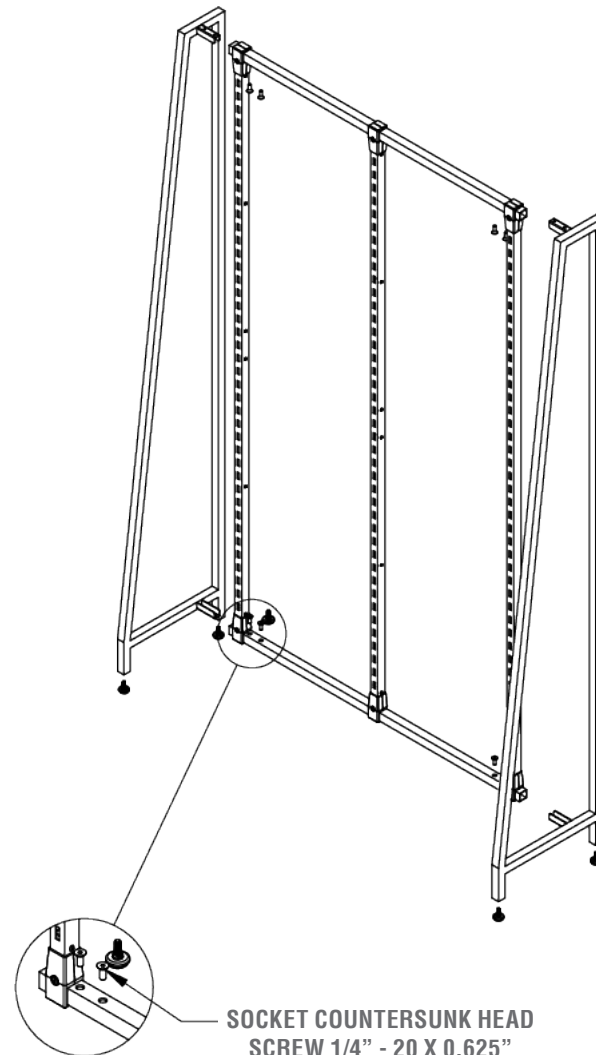
FIXTURE IS COMPLETE

COMPLETED
FIXTURE